

## SUPER FAST-CLEAN



### PISTON GUNSTOCK FILTERS

- Code 11039: Green (30M)
- Code 11038: White (60M)
- Code 11037: Yellow (100M)
- Code 11019: Red (200M)



| *Code-nozzle angle | Ø Inch | Ø mm | Product type   | Filter recom. |
|--------------------|--------|------|--|---------------|
| SFC07-20           | 0,007" | 0,18 | Transp. and pigmented paints, thin enamels                       | Red 200 M     |
| SFC07-40           |        |      |  |               |
| SFC09-20           | 0,009" | 0,23 |  |               |
| SFC09-40           |        |      |  |               |
| SFC11-20           | 0,011" | 0,28 | Nitro, synthetic and polyurethane paints                         | Yellow 100 M  |
| SFC11-40           |        |      |  |               |
| SFC13-20           | 0,013" | 0,33 |  |               |
| SFC13-40           |        |      |  |               |
| SFC13-60           |        |      |  |               |
| SFC15-20           | 0,015" | 0,38 | Antirust   |               |
| SFC15-40           |        |      |  |               |
| SFC15-60           |        |      |  |               |
| SFC17-20           | 0,017" | 0,43 |  |               |
| SFC17-40           |        |      |  |               |
| SFC17-60           |        |      |  |               |
| SFC19-20           | 0,019" | 0,48 | Primers, zinc inorganic, water paints                            | White 60 M    |
| SFC19-40           |        |      |  |               |
| SFC19-60           |        |      |  |               |
| SFC21-20           | 0,021" | 0,53 |  |               |
| SFC21-40           |        |      |  |               |
| SFC21-60           |        |      |  |               |
| SFC23-20           | 0,023" | 0,58 |  |               |
| SFC23-40           |        |      |  |               |
| SFC23-60           |        |      |  |               |
| SFC25-20           | 0,025" | 0,63 | Thixotropic, stucco spray, high solid, paints with glue, fillers |               |
| SFC25-40           |        |      |  |               |
| SFC25-60           |        |      |  |               |
| SFC27-20           | 0,027" | 0,68 |  |               |
| SFC27-40           |        |      |  |               |
| SFC27-60           |        |      |  |               |
| SFC27-80           |        |      |  |               |
| SFC29-20           | 0,029" | 0,74 |  |               |
| SFC29-40           |        |      |  |               |
| SFC29-60           |        |      |  |               |
| SFC29-80           |        |      |  |               |
| SFC31-40           | 0,031" | 0,79 |  |               |
| SFC31-60           |        |      |  |               |
| SFC31-80           |        |      |  |               |
| SFC33-40           | 0,033" | 0,83 |  |               |
| SFC33-60           |        |      |  |               |
| SFC33-80           |        |      |  |               |
| SFC35-40           | 0,035" | 0,89 |  |               |
| SFC37-40           | 0,037" | 0,94 |  |               |
| SFC39-40           | 0,039" | 1,00 |  |               |
| SFC39-60           |        |      |  |               |
| SFC39-80           |        |      |  |               |
| SFC41-40           | 0,041" | 1,05 |  | Green 30 M    |
| SFC43-40           | 0,043" | 1,10 |  |               |
| SFC43-60           |        |      |  |               |
| SFC43-80           |        |      |  |               |
| SFC45-60           | 0,045" | 0,15 |  |               |
| SFC47-60           | 0,47"  | 1,20 |  |               |
| SFC51-60           | 0,051" | 1,30 |  |               |
| SFC51-80           |        |      |  |               |

- Compatible with all Airless guns
- Rapid replacement of working nozzle
- Rapid safe cleaning
- Maximum working pressure 350 bar (5075 psi)
- Long lasting carbon-tungsten insert
- Excellent finish

MANUFACTURER:

# LARIUS

23801 CALOLZIOCORTE - LECCO - ITALY - Via Antonio Stoppani, 21  
Tel. (39) 0341/62.11.52 - Fax (39) 0341/62.12.43  
E-mail: larius@larius.com - Internet http://www.larius.com



CUSTOMERS TECHNICAL SERVICE

Tel. (39) 0341/621256  
Fax (39) 0341/621234

# LARIUS

PAINT SPRAYING EQUIPMENT  
www.larius.eu



## AT300 AIRLESS GUN

M16x1,5

Code 11000

Professional gun at high pressure

1/4"

Cod. 11090



With device-Clean Super Fast

Ed. 005 | 06 - 12

# AT300 AIRLESS GUN

at high pressure

| Pos. | Code       | Description             | Pos. | Code    | Description                |
|------|------------|-------------------------|------|---------|----------------------------|
| A    | See table* | Nozzle Super Fast Clean | 10   | 11024   | Sleeve sealing             |
| 1    | 18270      | Body Super Fast Clean   | 11   | 11025   | Screw press sleeve         |
| 2    | 18280      | Gasket Super Fast Clean | 12   | 11026 + | Plate +                    |
| 3    | 11004      | Sleeve                  |      | 11027   | M3 nut                     |
| 4    | 11005      | Prick punch complete    | 13   | 11028   | Spring                     |
| 5    | 11008      | Trigger gen             | 14   | 11029   | Adjustment knob            |
| 5a   | 11010      | Safety lever            | 15   | 11020   | Gasket                     |
| 5b   | 11011      | Brake Washer            | 16   | -       | Filter                     |
| 5c   | 11009      | Trigger                 | 17   | 11018   | Handgrip                   |
| 5d   | 11012      | Pin                     | 18   | 3085 +  | Safety for hand +          |
| 5e   | 11013      | Pin                     |      | 11032   | 3 screws TSP 3x8           |
| 5f   | 11034/1    | Pin                     | 19   | 11017   | Spring                     |
| 5g   | 11027      | Nut M3                  | 20   | 32010   | Copper washer              |
| 5h   | 11016      | Washer                  | 21   | 11015   | Articulated joints M16x1,5 |
| 6    | 11007      | Gun body                |      | 10155   | Articulated joints 1/4"    |
| 7    | 11021      | Pins                    |      |         |                            |
| 8    | 11022      | Spring Bauer 11x6x0.6   |      |         |                            |
| 9    | 11023      | Wedge                   |      |         |                            |

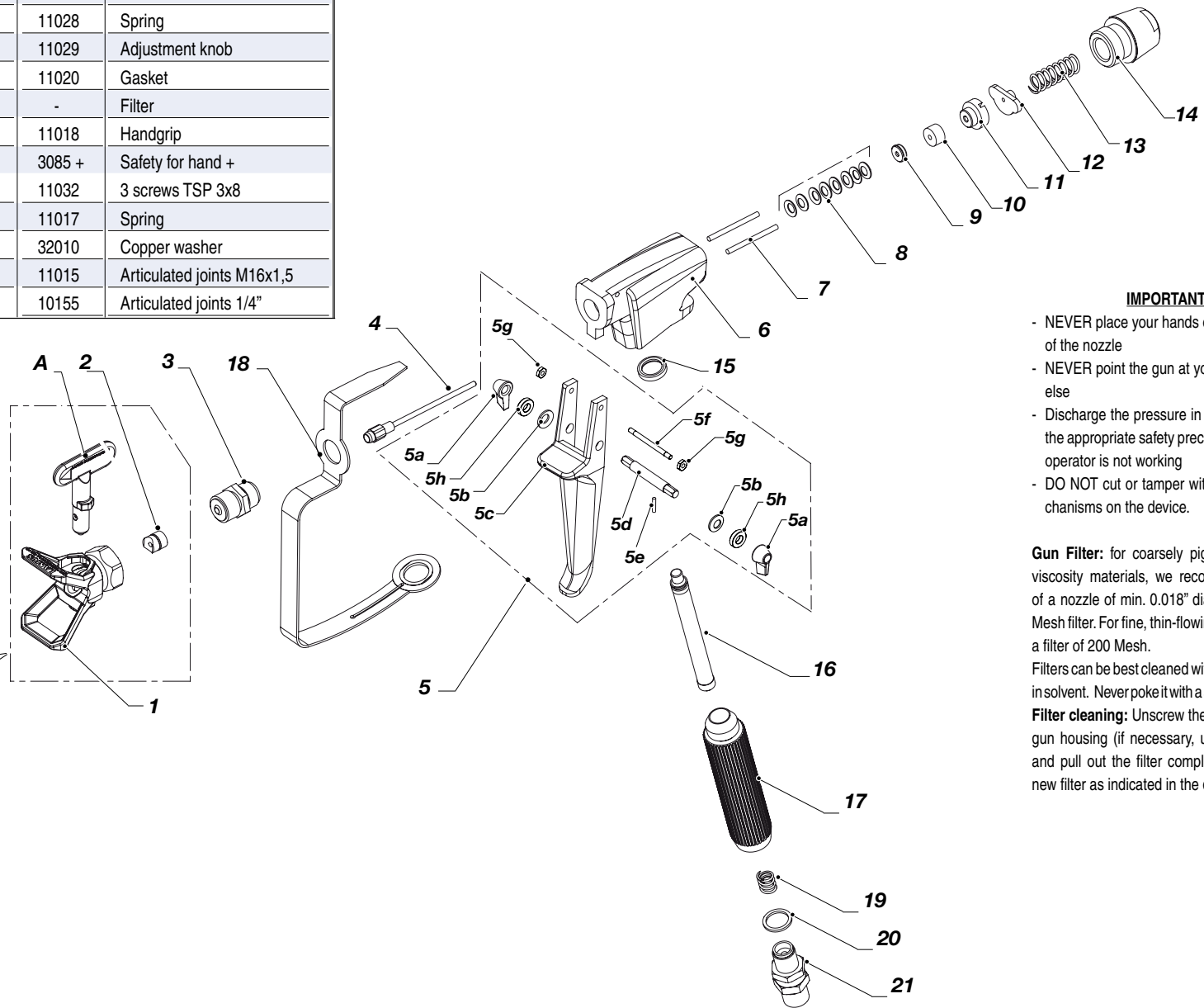

### IMPORTANT!

- NEVER place your hands or fingers in front of the nozzle
- NEVER point the gun at yourself or anyone else
- Discharge the pressure in the gun and use the appropriate safety precautions when the operator is not working
- DO NOT cut or tamper with the safety mechanisms on the device.

**Gun Filter:** for coarsely pigmented or high viscosity materials, we recommend the use of a nozzle of min. 0.018" diameter and a 50 Mesh filter. For fine, thin-flowing materials, use a filter of 200 Mesh.

Filters can be best cleaned with a brush dipped in solvent. Never poke it with a sharp instrument.

**Filter cleaning:** Unscrew the handle from the gun housing (if necessary, use gun spanner and pull out the filter completely). Insert the new filter as indicated in the drawing.